

Data sheet full face mask XP 6300 MAGMA

This full-face respirator from MAGMA provides comfortable, lightweight, and affordable lung and face protection. The MAGMA XP 6300 Series Full Face Mask combines technological innovation with ergonomic comfort to offer the best in respiratory protection.

Filters and cartridges are sold separately.

If you are working on the heating vents or ducts, popcorn ceilings, automotive brake linings, or pipe insulation, we recommend wearing an asbestos mask.



Design

This MAGMA respirator is exceptionally lightweight to accommodate the face protector needs of workers in diverse job environments. In fact, it is the lightest of all popular full face respirators on the market. The full face ventilator weighs less than 12.7 ounces, providing all-day comfort that makes workers more inclined to wear the protective facemask. Using innovative frameless construction technology, the reusable respirator is also designed for durability with harness straps molded securely onto the flange and a scratch resistant lens secured with a revolutionary over-molded flange design rather than clunky clamping found on other reusable respirators.

Comfort

The affordable, reusable XP 6300 Series full-face breathing mask gets high marks for comfort with its slide-on head harness with a wide opening and one finger ratchet fastening strap release system that makes it a breeze putting the mask on and off. The facepiece also features a super wide, full face viewing lens which provides a larger field of vision.

Integrated Exhalation

With an exhale valve built-in and an easy lock system, attaching filters and cartridges to the breathing mask is a breeze.

Easy Maintenance

Despite its sophisticated design, this lightweight respirator is easy to maintain. That's because there are fewer parts to worry about and absolutely no metal parts. What's more, the lens is easy to clean and its design eliminates scratching when the safety respirator mask is put down. All these features make maintenance of the MAGMA XP 6300 Series Full Face Mask Respirator effortless and less costly.

Specifications:

- **Accelerated Aging/Conditioning Tests:** The full face mask respirator withstood temperatures of 160 degrees F and 90% relative humidity for 7 days AND negative 10 degrees below F and 10% relative humidity for 7 days.
- **Lens Tests:** The face shield lens did not get damaged when a 1 pound, 1.63 ounce projectile with a pointed edge was dropped from a height of 50 inches. In addition, the lens remained intact when a 0.25-inch steel ball traveling at a speed of 250 feet per second hit it. The perfect scores achieved by this safety facepiece in these tests comply with the high impact eye protection standard under ANSI Z87 and other ANSI standards for safety glasses.
- **Strap Cycle Tests:** The respirator mask strap remained intact after it was put on and off 500 times. Plus, the harness, buckles, and straps did not falter after a 10-pound weight was put on and taken off them more than 250,000 times.
- **Exhale Valve Cover Cycle Test:** After being opened and closed 15,000 times, the exhale valve cover on the respirator remained good as new.
- **Cartridge Cycle Test:** The cartridges used with this full face breathing apparatus were attached and removed 500 times, yet remained in tip-top shape.



| | |
|----------------|--------------|
| COLOR: | BLACK |
| WEIGHT: | 500 GRM |
| WIDTH: | 250 MM |
| HEIGHT: | 200 MM |
| DEPTH: | 35 MM |

Type: Class1 full face masks for light duty use

Material: Thermo Plastic Elastomer/Rubber

Colour: Black

Harness: 5-point comfort harness with 2 grip holes for easier fitting on and removing with gloves and accommodation of women's hair (ability to wear a pony tail). Withstands a pull of up to 15KG or 150N

Visor: Polycarbonate anti-fog and impact resistant with peripheral optical vision of 220 degree's (110 on the left and right). The natural field of vision is greater than the 70% specified of EN136:2008 standards. One size mask

body: Accommodates small to large facial size's

Temperature: Designed to withstand temperatures of up to 70 ± 3° Light weight single filter cartridge system evenly distributes weight of mask and cartridges on the face.

Because the workplace facemask is metal-free and PVC-free, it is the perfect choice for refinery safety equipment, mine safety equipment, and for other industries where the use of metal equipment can be hazardous.

The full face oxygen mask is also ideal for medical lab safety, automotive safety, and waste processing.

From hazmat workers to auto body and refinishing workers to textile workers, the MAGMA XP 6300 Series

Full Face mask Respirator fits any job where odors and

irritants are a concern. When it comes to inexpensive respirators

for your own business or to meet your workplace respiratory protection program, there's no better deal than this full face respirator.



No matter your occupational safety or environmental safety concerns, this lightweight facemask accommodates all types of filtering cartridges. It provides OSHA, ANSI and NIOSH compliant lung protection for employees in chemical manufacturing, foundries, aluminum processing, boat building, electroplating and jobs using paint, embalming fluids, adhesives, or other lung-irritating odors. As a gas mask, it accommodates filtering cartridges that protect against hazardous gas and vapors.

For a user-friendly air purifying respirator, no other compares with the MAGMA XP 6300 Series Full Face mask Respirator. It's industrial safety gear that fits your compliance requirements and meets the wearability concerns of your workers. You might think that all this innovative technology and multitude of features would cost more, but in fact, this reusable full face respirator, complete with a tear away lens protector and reusable storage bag, is priced to meet your budget. Take the lead in your industry and equip your employees with the leading safety full face mask respirator for better workforce production and compliance.

Chemical agent permeation resistance : FP-C with 125-CBRN1 canister tested on breathing machine set at 40 l/min against distilled sulphur mustard (HD) and sarin (GB) as per table below:

| Agent | Conc. | Dur. (min) | Max b'thru (mg-min/m ³) | Min serv. life (h) |
|-----------|-----------------------|------------|-------------------------------------|--------------------|
| HD-vapour | 50 mg/m ³ | 30 | 3.0 | 8 |
| HD-liquid | 0.43 – 0.86 ml | 120 | 3.0 | 2 |
| GB | 210 mg/m ³ | 30 | 1.05 | 8 |



| No. | DESCRIPTION | NO. | DESCRIPTION. |
|------|---------------------------------------|------|-------------------------------------|
| DX1 | Harness | DX11 | Face cup value support-side valve |
| DX2 | Full face sealing | DX12 | Mask body |
| DX3 | Clear visor | DX13 | Valve seal ring-front |
| DX4 | Metal buckle | DX14 | Exhalation valve support front |
| DX5 | Adjustable clip | DX15 | Exhalation valve diaphragm |
| DX6 | Full mask frame-top | DX16 | Exhalation valve cover-front |
| DX7 | Full mask frame-base | DX17 | Valve seal ring-side |
| DX8 | M4 stainless steel support-side valve | DX18 | Inhalation valve support-side valve |
| DX9 | M4 copper nut | DX19 | Inhalation valve diaphragm |
| DX10 | Inhalation valve | | |

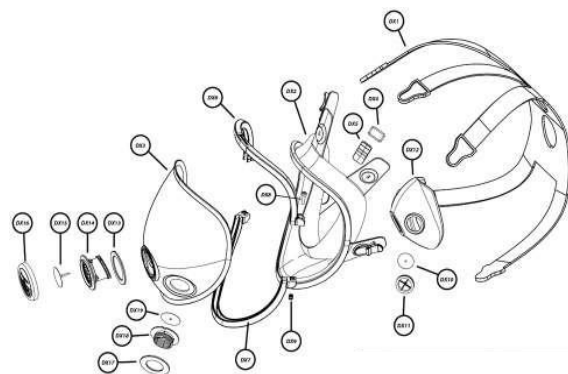

Cleaning:

Use a lukewarm water and mild detergent (neutral pH 6-8). Do not use solvents (like turpentine, acetone), hot water or bleaching agents (like Perborate, Percarbonate). After cleaning, disinfect the inside/faceseal with a disinfection solution eg, Trigene.

STORAGE

The Promask Single respirator should be protected from direct sunlight, grease and oil. The store should be dry and cool. The components should not be more than 5 years old

Storage of respirator: -10°C...+50°C, and relative humidity (RH) under 75%.

Storage of respirator and filters: -10°C...+30°C, max RH 75%. After use, an opened filter must be sealed tightly if it is to be reused, but it must be replaced within 6 months at the latest.

Storage and maintenance of a filter: The filters are sealed in plastic bags by the manufacturer. Store the filters unopened in a clean place at even temperature, most appropriate at 0...+30°C and relative humidity below 75%. Sealed filters tolerate also conditions of -10...+50°C and below 95% RH. The storage period (month and year) for filters is marked on the filter tape. Do not try to regenerate the filters. Never clean the filters with compressed air or compressed water. After use, the filters are special refuse. Make sure that they are disposed of according to the filtered substance (gases or particles) in accordance with current waste treatment regulations.

DISPOSAL

As the respirator & filters are subject to dirt, dusts and liquids etc, they cannot be recycled. If the product is to be disposed of, it should be dismantled from the respirator and disposed of as solid waste. Please see local authority regulations for disposal advice and locations.

Packing :

